



CROWN

EVENTS & CONFERENCES

CROWN CONFERENCE CENTRE LEVEL | FLOOR PLAN



**CROWN CONFERENCE CENTRE GROUND LEVEL FLOOR PLAN**

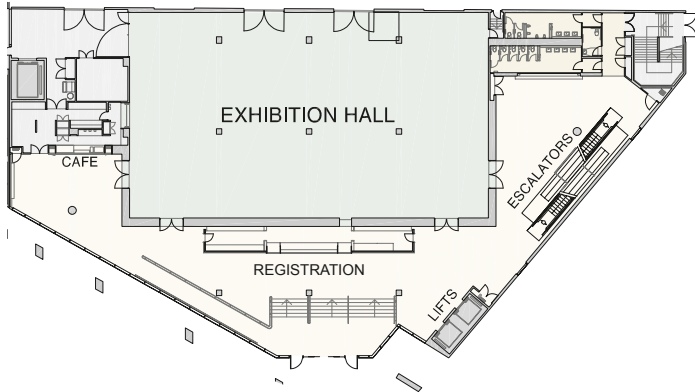

**CROWN CONFERENCE CENTRE LEVEL 2 FLOOR PLAN**

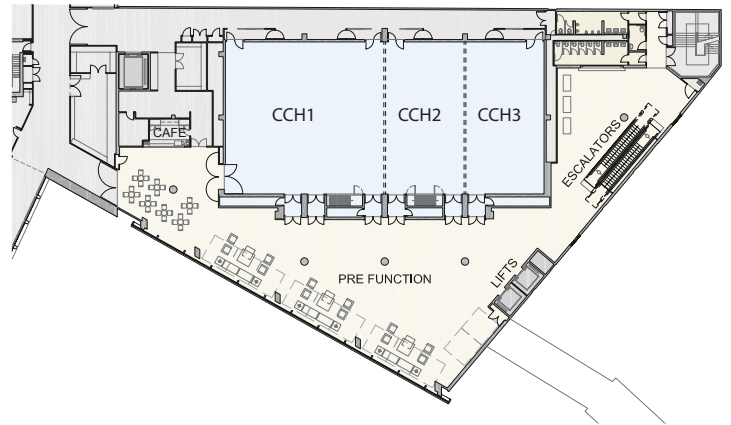

**CROWN CONFERENCE CENTRE - ROOM CAPACITIES**

AREA NAME	SPECIFICATIONS				FUNCTION ROOM SETUP STYLE						
	LENGTH (M)	WIDTH (M)	SQ.MT (M)	HEIGHT (M)	BANQUET STYLE	COCKTAIL RECEPTION	THEATRE STYLE	CLASSROOM STYLE	CABARET STYLE	U-SHAPE	BOARD ROOM
<b>Conference Hall</b>	35	17.4	609	5.5	420	800	840	414	336	NA	NA
CCH 1	17	17.4	296	5.5	180	300	330	180	144	NA	NA
CCH 2	9	17.4	156.5	5.5	90	150	170	90	72	50	NA
CCH 3	9	17.4	156.5	5.5	90	150	170	90	72	50	NA
CCH 1 & 2	26	17.4	452.5	5.5	270	450	570	270	216	NA	NA
CCH 2 & 3	18	17.4	313.0	5.5	180	300	330	180	144	NA	NA
<b>Exhibition Hall</b>	35.5	21	745.5	3.93	NA	NA	NA	NA	NA	NA	NA
<b>Promenade Room</b>	34.5	15.7	541.65	5.5	360	600	660	336	256	NA	NA
P1	18.5	15.7	290.45	5.5	160	300	338	156	128	54	NA
P2	8	15.7	125.6	5.5	80	150	132	72	64	36	NA
P3	8	15.7	125.6	5.5	80	150	132	72	64	36	NA
P1 & P2	26.5	15.7	416.1	5.5	240	450	520	255	224	NA	NA
P2 & P3	16	15.7	251.2	5.5	140	300	286	138	112	48	NA
M1	9.5	8	76	2.9	40	80	80	33	32	27	16
M2	8.5	8.5	72.25	2.9	40	80	80	42	32	27	16
M1 & 2	18	8	144	2.9	80	160	150	60	64	42	34
M3	10.5	6	63	2.9	30	50	68	27	24	24	20
M4	10.5	6	63	2.9	30	50	68	27	24	24	20
M3 & 4	10.5	12	126	2.9	80	120	134	63	48	33	26
M5	7	6	42	2.9	20	40	48	21	16	18	10
M6	13	9	117	2.9	60	100	92	39	40	24	22
M5 & 6	20	7.5	150	2.9	90	140	140	60	56	42	28
M7	10.5	4.5	47.25	2.9	20	50	42	21	16	15	16
M8	11.5	4.5	51.75	2.9	20	60	62	30	16	21	22
M7 & 8	11	9	99	2.9	50	110	102	42	32	27	16
M9	10	5.75	57.5	2.7	20	60	70	27	16	21	22
M10	13	6	78	2.7	30	80	93	39	24	27	28
M9 & 10	11.5	11.75	135.5	2.7	60	140	114	48	48	33	22
M11	8.9	14	123.5	2.7	80	120	134	63	64	36	NA
M12	9.1	8.3	75	2.7	40	80	80	36	32	27	16
M13	9.1	8.3	75	2.7	40	80	80	36	32	27	16
M12 & M13	18.2	8.3	150	2.7	80	160	140	90	64	42	28
M14	8.8	8	70	2.7	40	50	65	36	32	24	20
M15	8.2	8	70	2.7	40	50	65	36	32	24	20
M16	8.9	8	71	2.7	40	50	65	36	32	24	20
M15 & M16	17.1	8	136	2.7	80	130	104	72	72	27	26

Note: there is no A.V. allowance in any of the above setups